

Quick Installation Guide

PV Grid-connected Inverter

SG75CX-LV



- Contents may be periodically updated or revised due to product development. The information in this guide is subject to change without notice. In no case shall this guide substitute for the user manual or related notes on the device.
- Make sure to read over, fully understand and strictly follow the detailed instructions of the user manual and other related regulations. Visit <http://www.sungrowpower.com/>, choose "PV Inverters" and search for the device model on the "Products" tab page to view or obtain the user manual.
- All operations can be performed only by qualified personnel, that must be trained in the installation and commissioning of the electrical system, as well as the dealing with hazards, have knowledge of the manual and of the local regulations and directives.
- Before installation, check that the package contents are intact and complete against the packing list. Contact SUNGROW or the distributor in case of any damaged or missing components.
- The cable must be intact and well insulated. Operation personnel must wear proper personal protective equipment (PPE) all the time.
- Any violation could result in personal death or injury or device damage, and will void the warranty.

Safety

Please follow the safety instructions related to the PV strings and the utility grid. Otherwise, SUNGROW shall not be held liable for any damage caused.

DANGER

Lethal voltage!

- PV strings will produce electrical power when exposed to sunlight and can cause a lethal voltage and an electric shock.
- Only qualified personnel can perform the wiring of the PV panels.
- All electrical connections must be in accordance with local and national standards.
- Only with the permission of the utility grid, the inverter can be connected to the utility grid.
- Do not open the enclosure at any time. Unauthorized opening will void guarantee and warranty claims and in most cases terminate the operating license.
- When the enclosure lid is removed, live components can be touched which can result in death or serious injury due to electric shock.

WARNING

All the warning labels and nameplate on the inverter body must be clearly visible and not be removed, covered or pasted.

CAUTION

Risk of burns due to hot components!

Do not touch any hot parts (such as heat sinks) during operation. Only the DC switch can safely be touched at any time.

NOTICE

Only qualified personnel can perform the country setting.









Unauthorized alteration of the country setting may cause a breach of the type-certificate marking.

Security Declaration

To learn more about the product network security vulnerability response process and vulnerability disclosure, please scan the QR code below or visit the following website:

<https://en.sungrowpower.com/security-vulnerability-management>



 <p>Electrical hazard! Installation and operation must only be performed by qualified technical persons.</p>	 <p>Hot surface! Do not touch.</p>
  <p>After the inverter is disconnected from the external power source, wait at least 5 minutes before touching its internal conductive parts.</p>	 <p>Danger of high voltages! The inverter must be grounded before it is powered on.</p>
 <p>Do not dispose of the inverter as household waste.</p>	 <p>Read through the manual before performing any operation on the inverter.</p>
 <p>The inverter does not have a transformer.</p>	 <p>TUV mark of conformity.</p>

- O conteúdo pode ser periodicamente atualizado ou revisado devido ao desenvolvimento do produto. As informações contidas neste guia estão sujeitas a alterações sem aviso prévio. Sob nenhuma circunstância este guia deve substituir o manual do usuário ou avisos relacionados no dispositivo.
- Leia, entenda e siga rigorosamente as informações detalhadas no manual do usuário e outras regulamentações anteriores. Acesse <http://www.sungrowpower.com/>, escolha "Inversores FV" e pesquise o modelo do dispositivo na página da guia "Produtos" para visualizar ou obter o manual do usuário.
- As operações descritas neste documento só devem ser realizadas por profissionais qualificados, familiarizados com a instalação e comissionamento de sistemas elétricos, com a documentação do produto e com as normas e diretrizes aplicáveis.
- Antes de instalar, verifique se o conteúdo da embalagem está intacto e completo na lista da embalagem. Entre em contato com a SUNGROW ou com o distribuidor em caso de componentes danificados ou faltando.
- O cabo deve estar intacto e bem isolado. O pessoal da operação deve usar equipamento de proteção individual (EPI) o tempo todo. Qualquer violação pode causar ferimentos, morte ou danos ao dispositivo e anulará a garantia.

Segurança

Siga as instruções de segurança relacionadas às séries fotovoltaicas e à rede de distribuição. Caso contrário, a SUNGROW não se responsabiliza por qualquer dano causado.

PERIGO

Tensão letal!

- As séries fotovoltaicas produzirão energia elétrica quando expostas à luz do sol, podendo causar tensão fatal e choques elétricos letais.
- Somente funcionários qualificados podem fazer a fiação dos painéis FV.
- Todas as conexões elétricas devem estar de acordo com os padrões nacionais e locais.
- O inversor só poderá ser conectado à rede de distribuição com permissão da rede.
- Não abra o compartimento em nenhum momento. A abertura não autorizada anulará a garantia e quaisquer queixas de garantia e, na maioria dos casos, rescindir a licença de operação.
- Quando a tampa do compartimento for removida será possível tocar nos componentes ativos, o que pode causar mortes ou ferimentos graves por choques elétricos.

ADVERTÊNCIA

Todas as etiquetas de advertência e placas de identificação no corpo do inversor devem estar claramente visíveis e não podem ser removidas, cobertas ou coladas.

CUIDADO

Risco de queimaduras devido aos componentes quentes!

Não toque nas partes quentes (como os dissipadores de calor) enquanto o dispositivo estiver funcionando. Apenas a chave seccionadora CC pode ser tocada com segurança a qualquer momento.

AVISO

Apenas profissionais qualificados podem executar o ajuste local de acordo com o país.









A alteração não autorizada da configuração do país pode violar a certificação do dispositivo.

Declaração de segurança

Para obter detalhes sobre o processo de resposta a vulnerabilidades na segurança da rede e sobre a descoberta de vulnerabilidades do produto, escaneie o código QR à direita ou acesse este site:

<https://en.sungrowpower.com/security-vulnerability-management>



 <p>Perigo de choque elétrico! A instalação e a operação só devem ser realizadas por pessoal técnico qualificado.</p>	 <p>Superfície quente! Não toque.</p>
  <p>Depois de desconectar o inversor da fonte de energia externa, aguarde pelo menos 5 minutos antes de tocar nas partes condutoras internas.</p>	 <p>Risco de altas tensões! O inversor deve ser aterrado antes de ser ligado.</p>
 <p>Não descarte o inversor como resíduo comum.</p>	 <p>Leia atentamente este manual antes de realizar qualquer operação no inversor.</p>
 <p>O inversor não possui transformador.</p>	 <p>Marcação de conformidade CQC.</p>

Scope of Delivery / Escopo da entrega

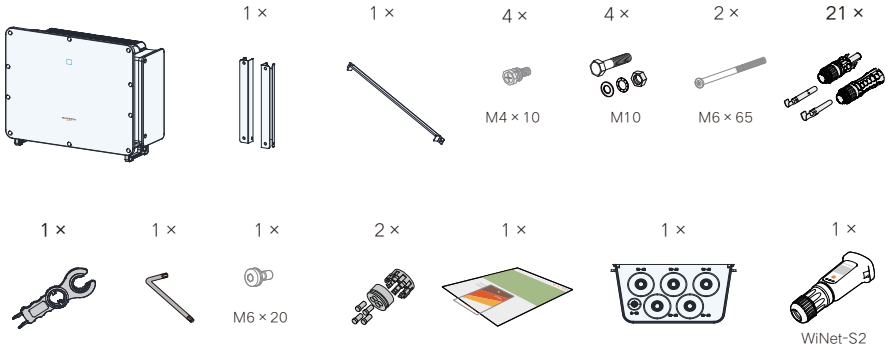

Installation Requirements / Requisitos de instalação

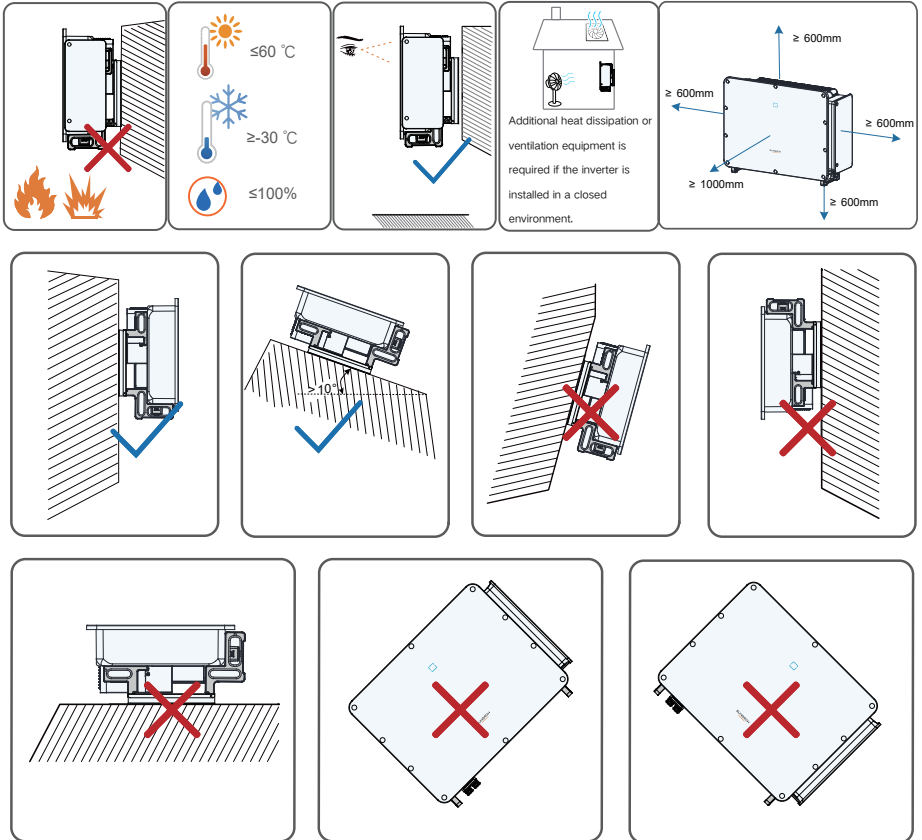

Backward installation is not applicable for floating power plants.

Overall Dimensions / Dimensões gerais

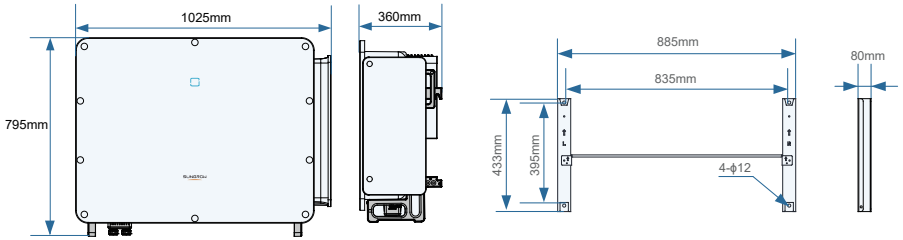

Inverter Mounting / Montagem do inversor

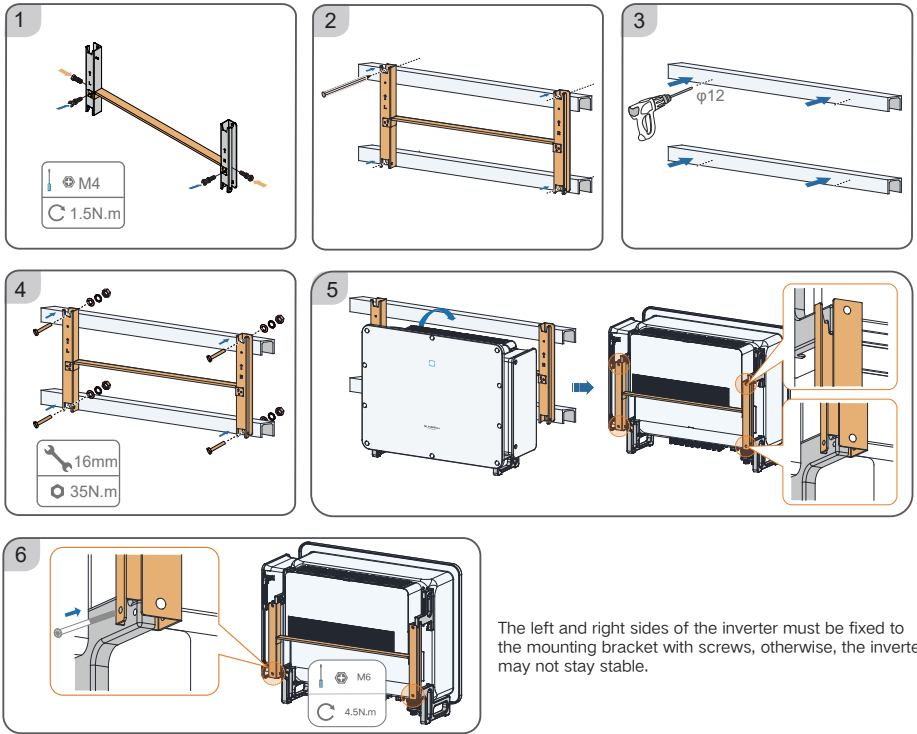

Grounding / Aterramento

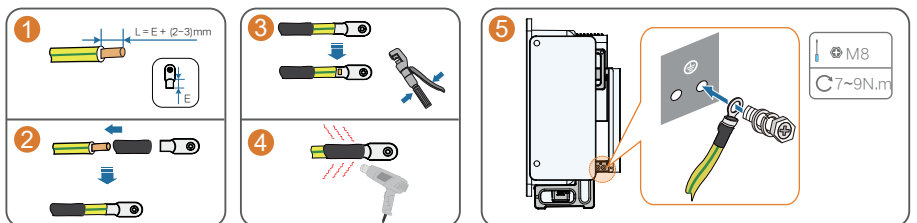

AC Wiring / Conexão CA

This section gives instructions on wiring using a five-core copper cable as an example.

1

OFF

2

3

4

40-60mm

5

50mm

6

T30
C 4.2~4.5N.m

7

$L = E + (2-3) \text{mm}$

D: 40~80mm

C: 120~300mm

E

If a multi-core cable is used, it is recommended that the strip length of the L2 wire be 15mm shorter than that of the L1 and L3 wires.

8

9

10

11

12

M12
C 35±5 Nm

L1 L2 L3 N PE

For the tightening torques for AC wiring terminals, see the torque label inside the AC junction box.

13

14

T30
C 4.2~4.5N.m

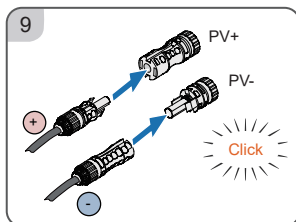
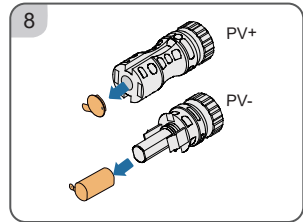
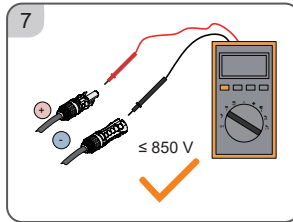
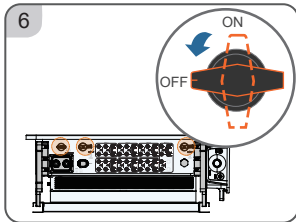
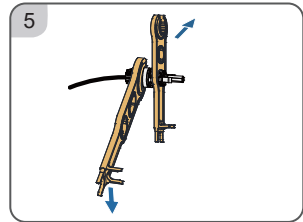
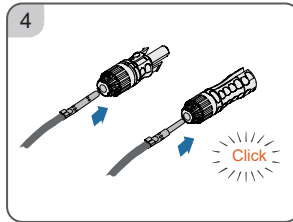
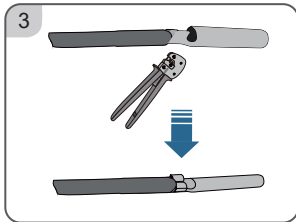
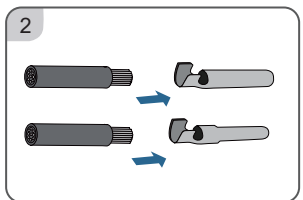
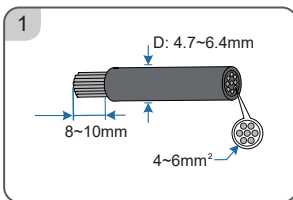
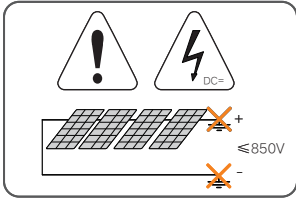

Communication Module Installation (Optional) / Instalação do módulo de comunicação (opcional)

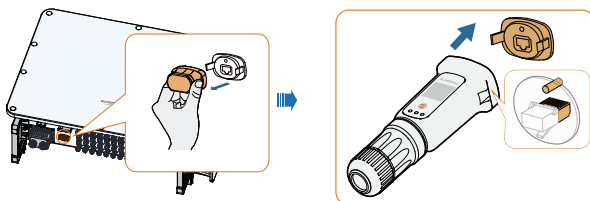

*The figure is for reference only and the real product may differ.

Installation with Ethernet communication

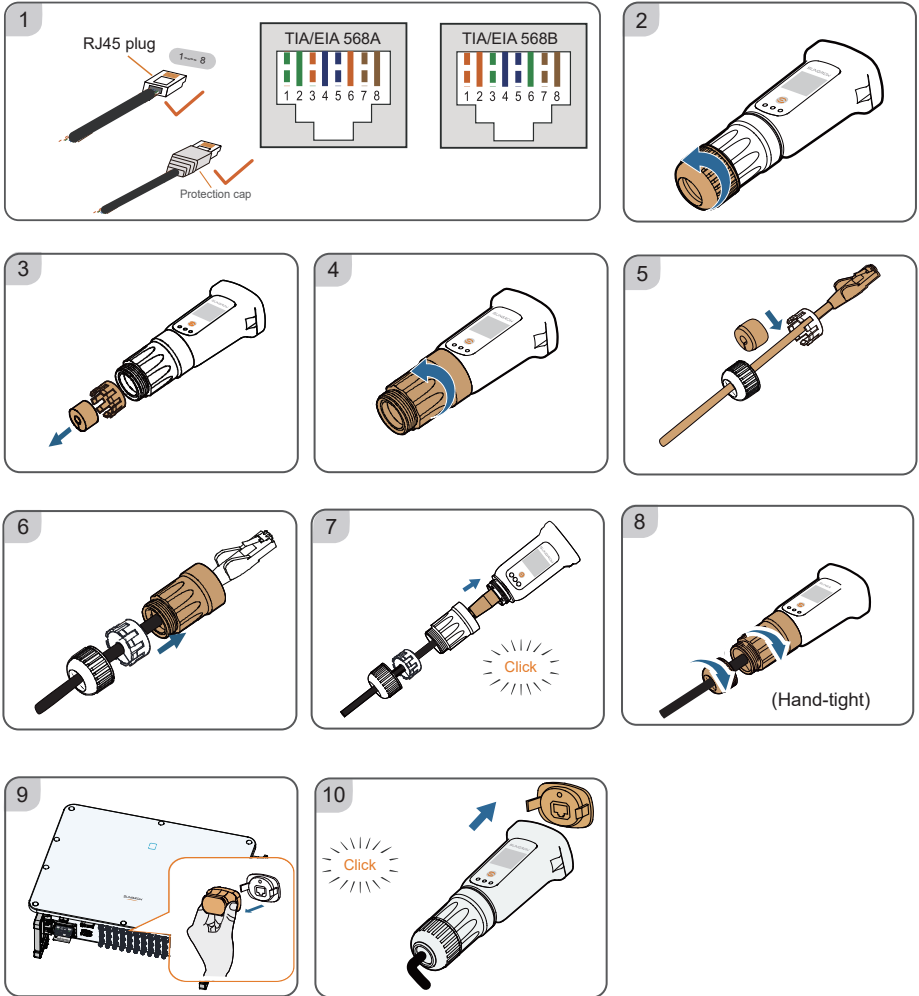

RS485_2				RS485_1							
A2	A2	B2	B2	RJ45		RJ45		A1	A1	B1	B1
RS485_3				LOCAL STOP				DRM		ALARM	
A3		B3	DI	DI	PGND	PGND	RJ45	COM	NC	NO	

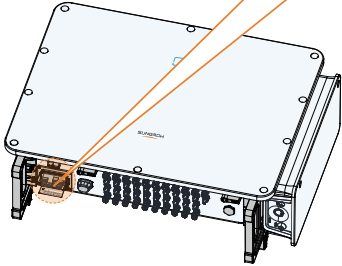

Wiring to Terminal Block

1

2

4.5-6mm	6-12mm	12-18mm
c	a+b	b

3

4

M2
0.2N.m

5

6

7

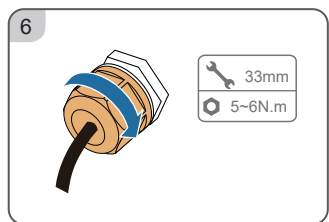
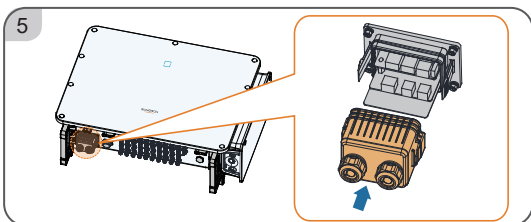
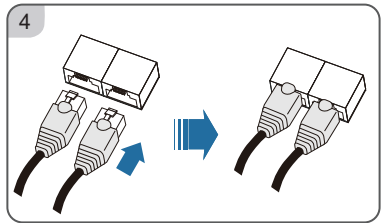
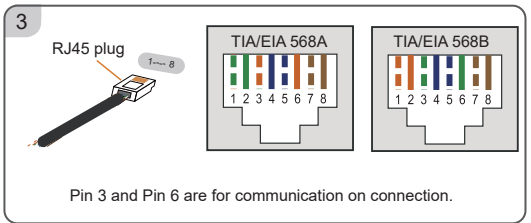
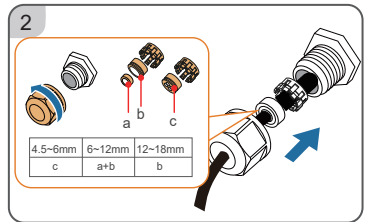
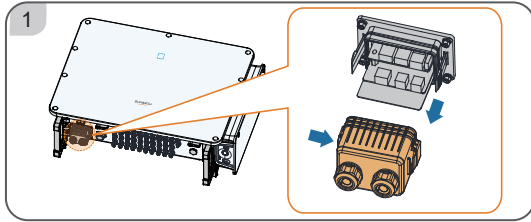

33mm
5-6N.m

RJ45

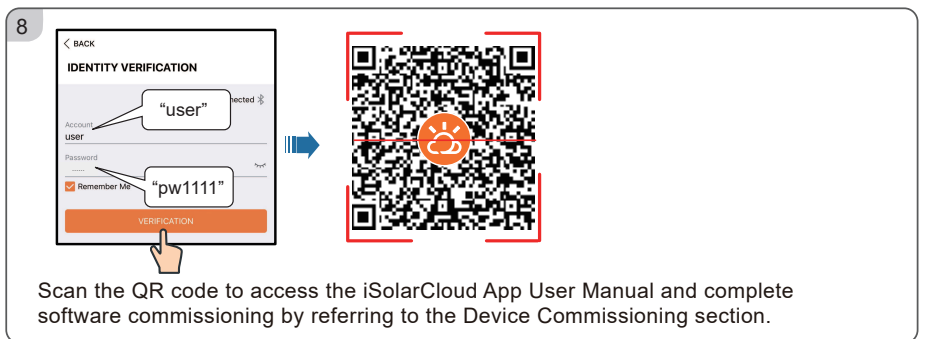
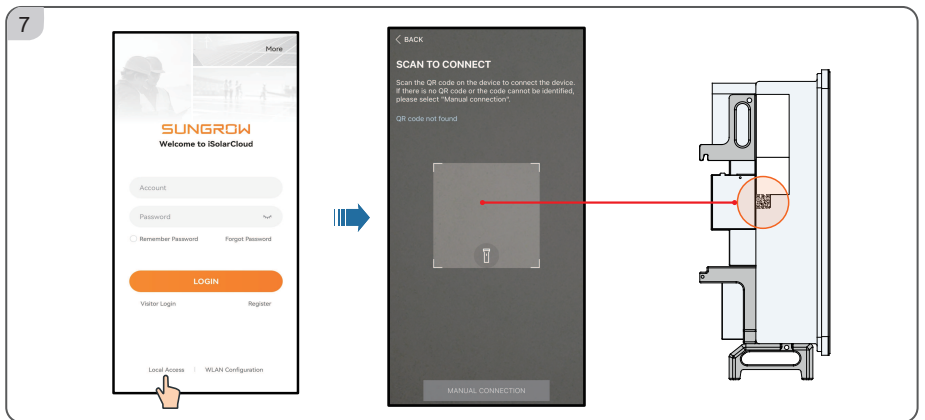
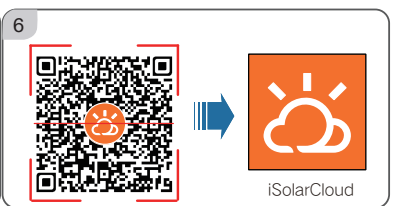
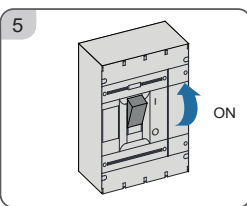
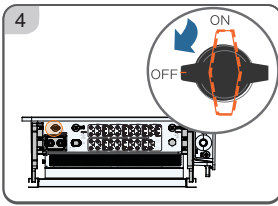
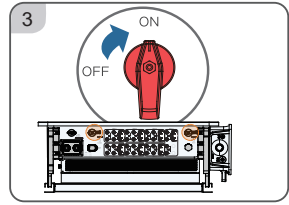
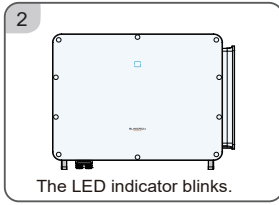
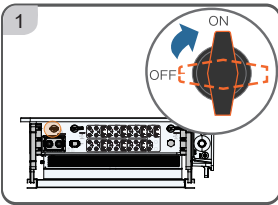



Scan the QR code to access the iSolarCloud App User Manual and complete software commissioning by referring to the Device Commissioning section.

LED color	State	Definition
	ON	The device is connected to the grid and operating normally.
	Fast blink (Period: 0.2s)	The Bluetooth communication is connected and there is data communication. No system fault occurs.
	Slow blink (Period: 2s)	The device is in standby or startup state (not feeding power into the grid).
	Slow blink once, fast blink three times	The inverter is performing PID recovery.
	ON	A fault occurs and the device cannot connect to the grid.
	Blink	The Bluetooth connection is established, data communication in process, and a system fault occurs.
	OFF	Both the AC and DC sides are powered down.



More information in the QR code or
at <http://support.sungrowpower.com/>